

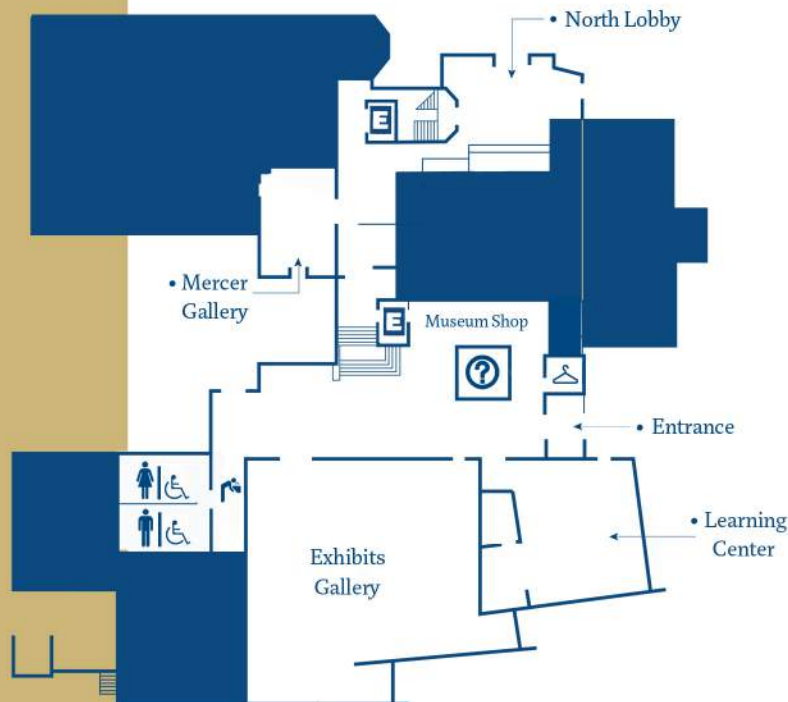

# Guide to the MERCER museum

**The Mercer Museum** presents a diverse array of programs and exhibitions on historical, cultural and artistic themes. Its core collection of preindustrial tools and artifacts of everyday life was founded in 1897 by Henry Mercer (1856-1930). Many of these materials are on permanent display in the reinforced concrete "castle" built under Mercer's direction between 1913 and 1916.

1



## Museum Shop

Located in our entry wing, the shop offers an assortment of quality handcrafted items including pottery, jewelry, tiles and educational toys, as well as a selection of books and souvenirs.

2

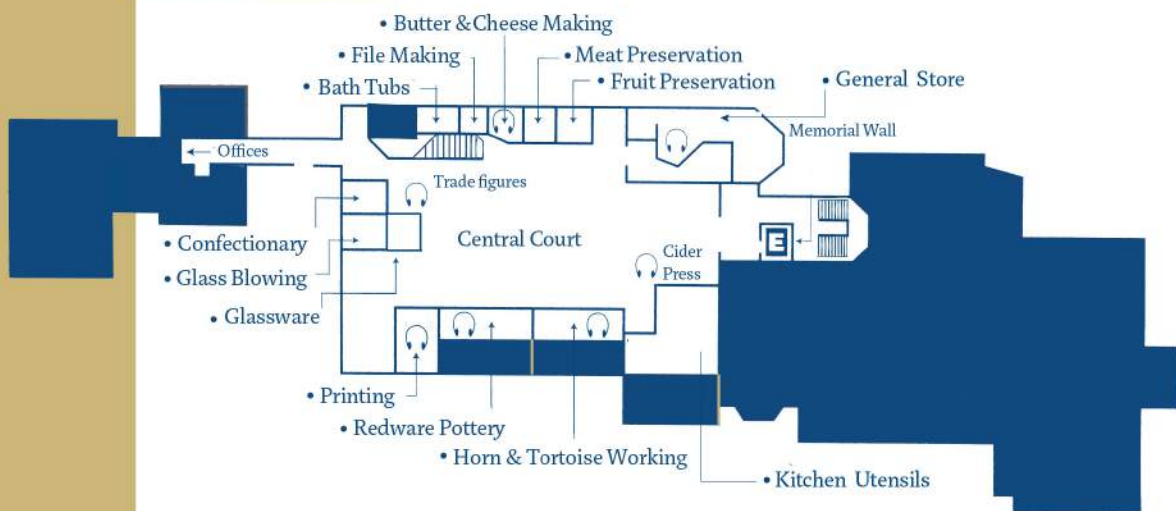

3

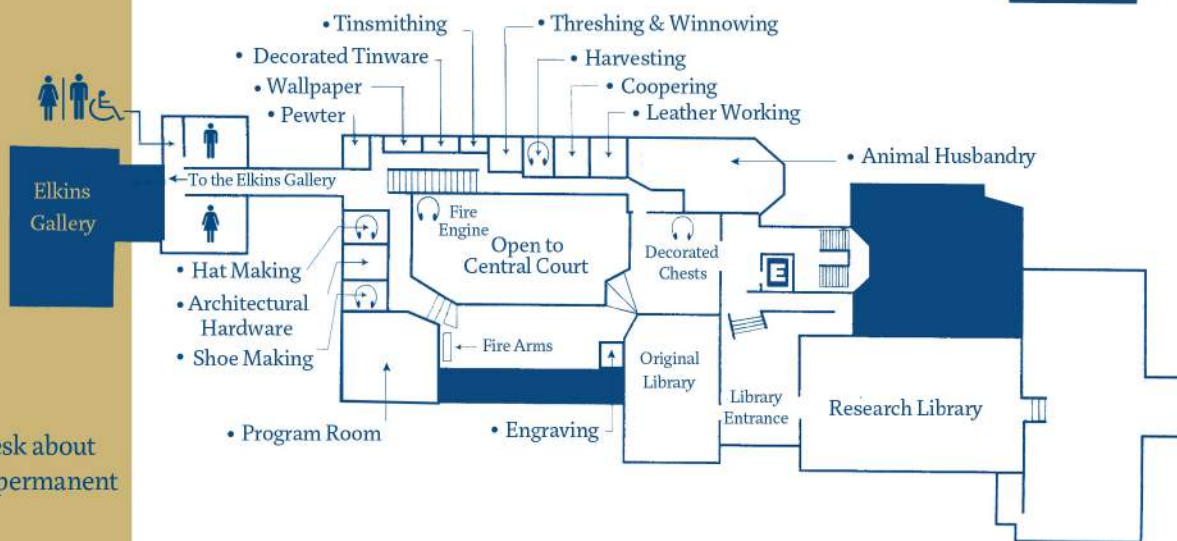

## Audio Guide

Ask at the reception desk about our audio guide to the permanent exhibits.

## General Information

- No food or drink in the museum
- No smoking
- Please do not touch objects on exhibit
- Use of hand-held cameras, including flash, is permitted throughout the museum unless explicitly excluded in changing exhibits.

## Research Library

The museum's Library, located on level 3, houses an extensive collection of materials related to Bucks County history and genealogy, including the County Archives. It also features a variety of primary and secondary sources on traditional crafts, trades and industries. Visitors may view Mercer's Moravian Tile mosaics in the original library room.

The library may be visited by museum guests during its regular hours: Tuesday-Thursday, 1-5 pm., Friday-Saturday, 10-5pm.

4

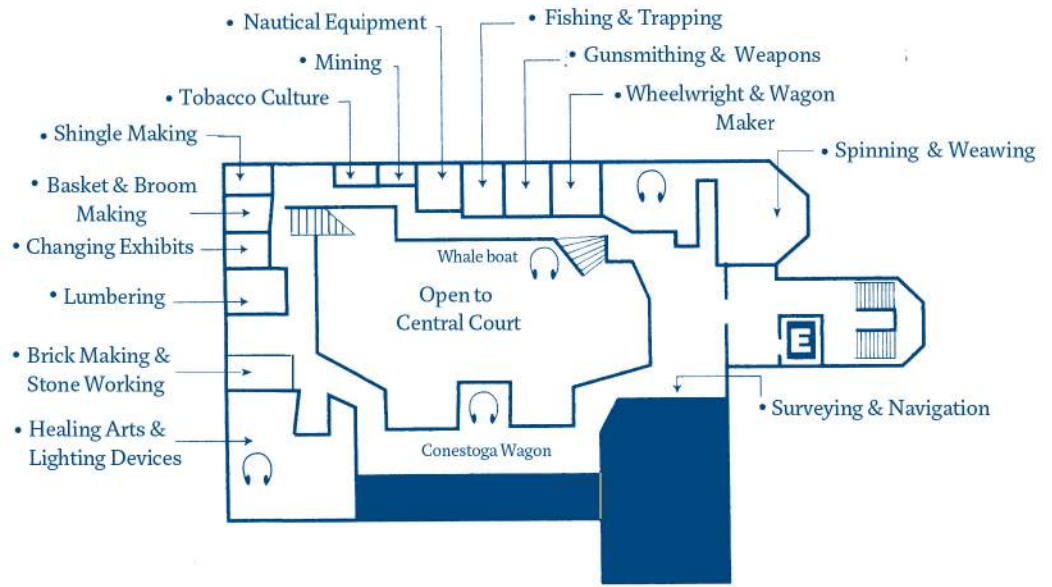

5



• **"Animals On The Loose"**  
 In this Gallery, young children may explore some of the museum's animal shaped collections in a fun, hands on exhibit.

6

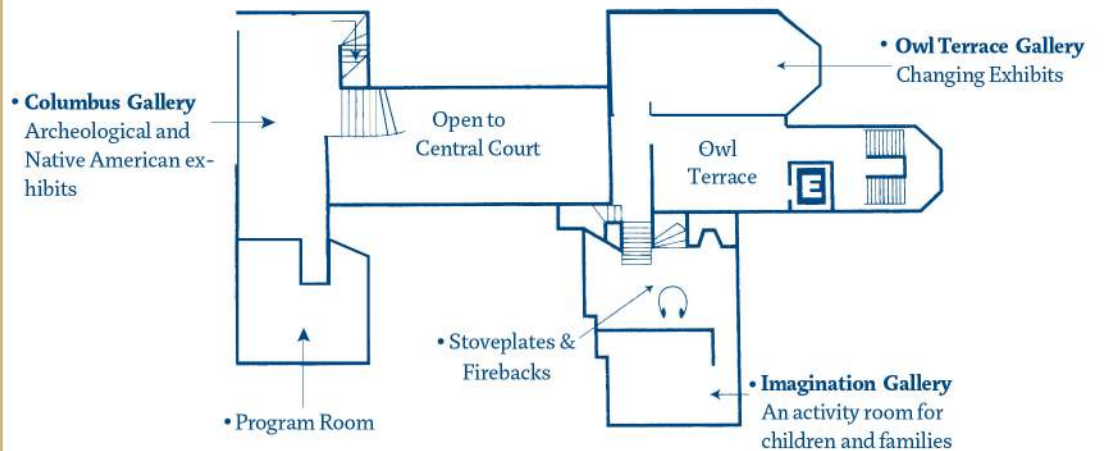

7

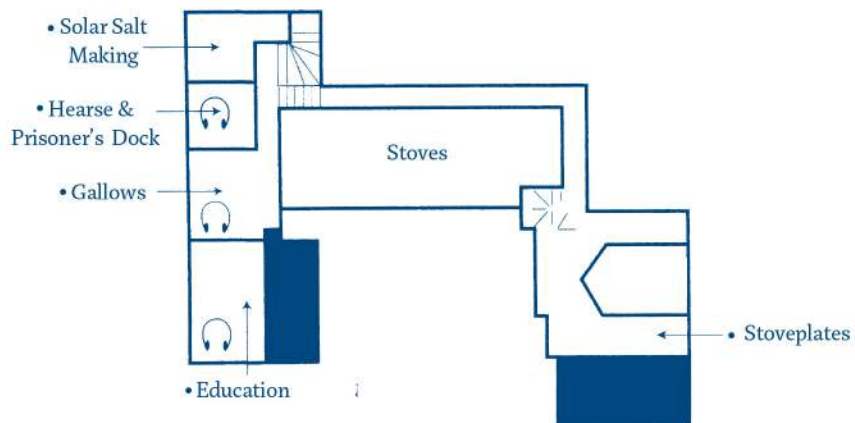

**Visit Fonthill Castle!**

Located a mile away, Henry Mercer's home is open for tours. See the Mercer Museum receptionist for tour times, or call 215-348-9461.



**MERCER**  
museum

Operated by  
The Bucks County  
Historical Society  
84 South Pine Street  
Doylestown, PA 18901  
215-345-0210  
mercermuseum.org



Accredited by the  
American Association  
of Museums